

TITAN accessories

CATALOG
2012

www.titanaccs.com

COAXIAL CONNECTORS

CONTENTS

PART 1	7/16 INNER CONNECTOR FOR COAXIAL CABLE 1.5/8"	3
PART 2	7/16 OUTER CONNECTOR FOR COAXIAL CABLE 1.5/8"	4
PART 3	N INNER CONNECTOR FOR COAXIAL CABLE 1.5/8"	5
PART 4	N OUTER CONNECTOR FOR COAXIAL CABLE 1.5/8"	6
PART 5	7/16 INNER CONNECTOR FOR COAXIAL CABLE 1.1/4"	7
PART 6	7/16 OUTER CONNECTOR FOR COAXIAL CABLE 1.1/4"	8
PART 7	N INNER CONNECTOR FOR COAXIAL CABLE 1.1/4"	9
PART 8	N OUTER CONNECTOR FOR COAXIAL CABLE 1.1/4"	10
PART 9	7/16 INNER CONNECTOR FOR COAXIAL CABLE 7/8"	11
PART 10	7/16 OUTER CONNECTOR FOR COAXIAL CABLE 7/8"	12
PART 11	N INNER CONNECTOR FOR COAXIAL CABLE 7/8"	13
PART 12	N OUTER CONNECTOR FOR COAXIAL CABLE 7/8"	14
PART 13	7/16 INNER CONNECTOR FOR COAXIAL CABLE 1/2"	15
PART 14	7/16 OUTER CONNECTOR FOR COAXIAL CABLE 1/2"	16
PART 15	N INNER CONNECTOR FOR COAXIAL CABLE 1/2"	17
PART 16	N OUTER CONNECTOR FOR COAXIAL CABLE 1/2"	18
PART 17	7/16 INNER CONNECTOR FOR COAXIAL CABLE 1/2" SUPER-FLEXIBLE	19
PART 18	7/16 OUTER CONNECTOR FOR COAXIAL CABLE 1/2" SUPER-FLEXIBLE	20
PART 19	N INNER CONNECTOR FOR COAXIAL CABLE 1/2" SUPER-FLEXIBLE	21
PART 20	N OUTER CONNECTOR FOR COAXIAL CABLE 1/2" SUPER-FLEXIBLE	22
PART 21	COAXIAL ADAPTERS (OUTER AND INNER)	23

7/16 INNER CONNECTOR FOR COAXIAL CABLE 1.5/8"

1. Connectors are manufactured in accordance with IEC60169-4 standard
2. Screw thread: M29 x 1.5 – 6g
3. Materials and covering

Item	Material	Covering
Outer conductor	Brass (H59-1)	Silver covering $\geq 3 \mu m$
Limiting screw nut	Brass (H59-1)	Nickel covering $\geq 3 \mu m$
Inner conductor	Bronze	Silver covering $\geq 5 \mu m$
Gasket	Silicon spacer	
Insulation	PTFE (teflon)	

4. Conditions

Working temperature: -40 ~ +85°C

Relative humidity: 90%~95% (40±2%)

Atmospheric pressure: 70~106Kpa

Salt fog: long-lasting fog for 48 hours (5% NaCl)

5. Dimensions:

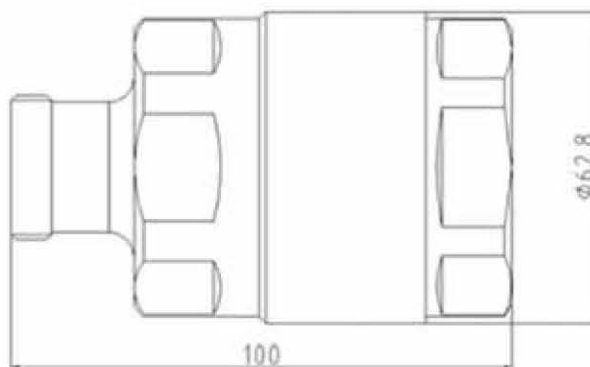

6. Electric characteristics:

Wave resistance, Ohm	Outer conductor	≤ 0.2
	Inner conductor	≤ 0.4
Insulation strength, Ohm		$\geq 10^4$
AC peak power (V/min)		4000
Voltage standing-wave ratio (VSWR)		≤ 1.10
IM3 (dB)		≤ 155

7/16 OUTER CONNECTOR FOR COAXIAL CABLE 1.5/8"

Connectors are manufactured in accordance with IEC60169-4 standard

Screw thread: M29 x 1.5 – 7H

Materials and covering

Item	Material	Covering
Outer conductor	Brass (H59-1)	Nickel covering $\geq 3 \mu m$
Limiting screw nut	Brass (H59-1)	Nickel covering $\geq 3 \mu m$
Inner conductor	Bronze	Silver covering $\geq 3 \mu m$
LOcking ring	Bronze	
Connecting nut	Brass (H59-1)	Nickel covering $\geq 3 \mu m$
Gasket	Silicon spacer	
Insulation	PTFE (teflon)	

1. Conditions

Working temperature: $-40 \sim +85^{\circ}C$

Relative humidity: 90% ~ 95% ($40 \pm 2\%$)

Atmospheric pressure: 70 ~ 106 kPa

Salt fog: long-lasting fog for 48 hours (5% NaCl)

2. Dimensions:

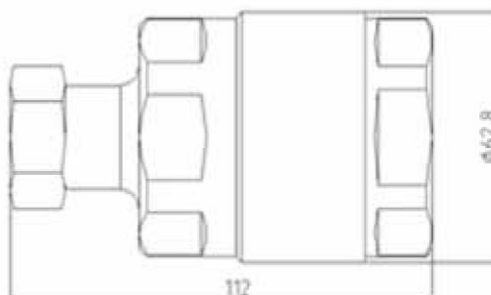

3. Electric characteristics:

Wave resistance, Ohm	Outer conductor	≤ 0.2
	Inner conductor	≤ 0.4
Insulation strength, Ohm		$\geq 10^4$
AC peak power (V/min)		4000
Voltage standing-wave ratio (VSWR)		≤ 1.10

N INNER CONNECTOR FOR COAXIAL CABLE 1.5/8"

1. Connectors are manufactured in accordance with IEC60169-16 standard
2. Screw thread: 5/8-24UNEF-2B
3. Materials and covering

Item	Material	Covering
Outer conductor	Brass (H59-1)	Silver covering $\geq 3 \mu m$
Limiting screw nut	Brass (H59-1)	Nickel covering $\geq 3 \mu m$
Inner conductor	Bronze	Golden covering
Gasket	Silicon spacer	
Insulation	PTFE (teflon)	

4. Conditions

Working temperature: $-40 \sim +85^{\circ}C$

Relative humidity: 90% ~ 95% ($40 \pm 2\%$)

Atmospheric pressure: 70 ~ 106 kPa

Salt fog: long-lasting fog for 48 hours (5% NaCl)

5. Dimensions:

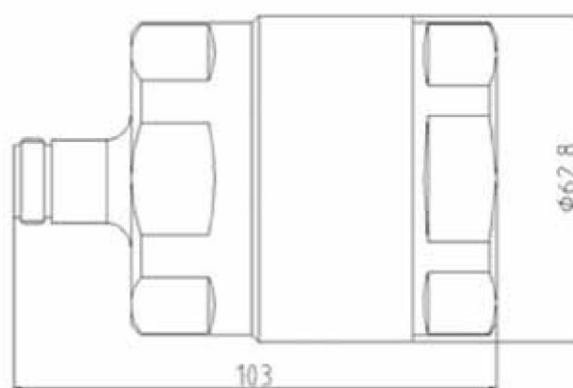

6. Electric characteristics

Wave resistance, Ohm	Outer conductor	≤ 0.25
	Inner conductor	≤ 1
Insulation strength, Ohm		≥ 5000
AC peak power (V/min)		2500
Voltage standing-wave ratio (VSWR)		≤ 1.10

N OUTER CONNECTOR FOR COAXIAL CABLE 1.5/8"

Connectors are manufactured in accordance with IEC60169-16

Screw thread: 5/8 -24UNEF-2A

Materials and covering

Item	Material	Covering
Outer conductor	Brass (H59-1)	Nickel covering $\geq 3 \mu m$
Limiting screw nut	Brass (H59-1)	Nickel covering $\geq 3 \mu m$
Inner conductor	Bronze	Golden covering
Locking ring	Bronze	
Connecting nut	Brass (H59-1)	Nickel covering $\geq 3 \mu m$
Gasket	Silicon spacer	
Insulation	PTFE (teflon)	

1. Conditions

Working temperature: $-40 \sim +85^{\circ}C$

Relative humidity: 90% ~ 95% ($40 \pm 2\%$)

Atmospheric pressure: 70 ~ 106 kPa

Salt fog: long-lasting fog for 48 hours (5% NaCl)

2. Dimensions:

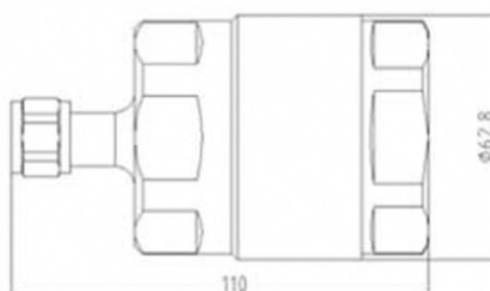

3. Electric characteristics:

Wave resistance, Ohm	Outer conductor	≤ 0.25
	Inner conductor	≤ 1
Insulation strength, Ohm		≥ 5000
AC peak power (V/min)		2500
Voltage standing-wave ratio (VSWR)		≤ 1.10

7/16 INNER CONNECTOR FOR COAXIAL CABLE 1.1/4"

1. Connectors are manufactured in accordance with IEC60169-4 standard
2. Screw thread: M29 x 1.5 – 6g
3. Materials and covering

Item	Material	Covering
Outer conductor	Brass (H59-1)	Nickel covering $\geq 3 \mu m$
Limiting screw nut	Brass (H59-1)	Nickel covering $\geq 3 \mu m$
Inner conductor	Bronze	Silver covering $\geq 5 \mu m$
Gasket	Silicon spacer	
Insulation	PTFE (teflon)	

4. Conditions

Working temperature: $-40 \sim +85^{\circ}C$

Relative humidity: 90%~95% ($40 \pm 2\%$)

Atmospheric pressure: 70~106Kpa

Salt fog: long-lasting fog for 48 hours (5% NaCl)

5. Dimensions:

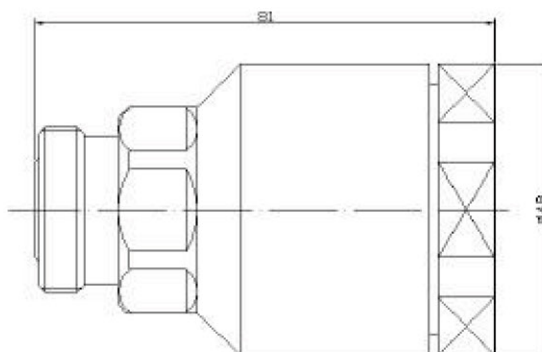

6. Electric characteristics:

Wave resistance, Ohm	Outer conductor	≤ 0.2
	Inner conductor	≤ 0.4
Insulation strength, Ohm		$\geq 10^4$
AC peak power (V/min)		4000
Voltage standing-wave ratio (VSWR)		≤ 1.10

7/16 INNER CONNECTOR FOR COAXIAL CABLE 1.1/4"

1. Connectors are manufactured in accordance with IEC60169-4 standard
2. Screw thread: M29 x 1.5 – 7H
3. Materials and covering

Item	Material	Covering
Outer conductor	Brass (H59-1)	Silver covering $\geq 3 \mu m$
Limiting screw nut	Brass (H59-1)	Nickel covering $\geq 3 \mu m$
Inner conductor	Bronze	Silver covering $\geq 3 \mu m$
Locking ring	Bronze	
Connecting nut	Brass (H59-1)	Nickel covering $\geq 3 \mu m$
Gasket	Silicon spacer	
Insulation	PTFE (teflon)	

4. Conditions

Working temperature: -40 ~ +85°C

Relative humidity: 90%~95% (40±2%)

Atmospheric pressure: 70~106Kpa

Salt fog: long-lasting fog for 48 hours (5% NaCl)

5. Dimensions:

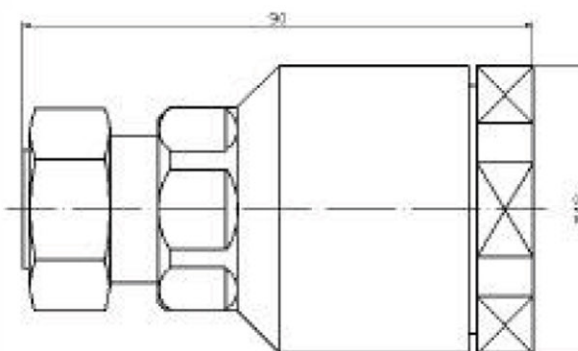

6. Electric characteristics:

Wave resistance, Ohm	Outer conductor	≤ 0.2
	Inner conductor	≤ 0.4
Insulation strength, Ohm		$\geq 10^4$
AC peak power (V/min)		4000
Voltage standing-wave ratio (VSWR)		≤ 1.10

N INNER CONNECTOR FOR COAXIAL CABLE 1.1/4"

1. Connectors are manufactured in accordance with IEC60169-16 standard
2. Screw thread: 5/8-24UNEF-2B
3. Materials and covering

Item	Material	Covering
Outer conductor	Brass (H59-1)	Nickel covering $\geq 3 \mu m$
Limiting screw nut	Brass (H59-1)	Nickel covering $\geq 3 \mu m$
Inner conductor	Bronze	Golden covering
Gasket	Silicon spacer	
Insulation	PTFE (teflon)	

4. Conditions

Working temperature: $-40 \sim +85^{\circ}C$

Relative humidity: 90% \sim 95% ($40 \pm 2\%$)

Atmospheric pressure: 70 \sim 106 kPa

Salt fog: long-lasting fog for 48 hours (5% NaCl)

5. Dimensions:

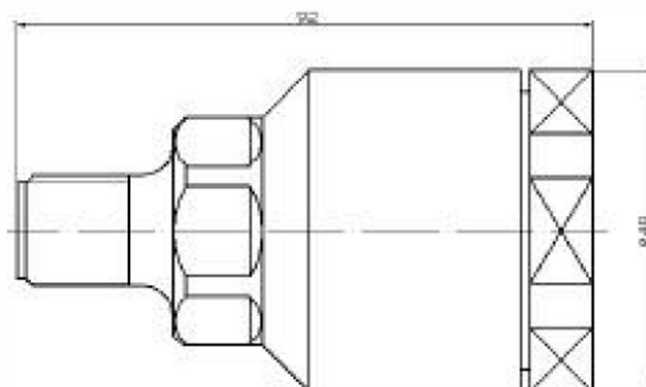

6. Electric characteristics

Wave resistance, Ohm	Outer conductor	≤ 0.25
	Inner conductor	≤ 1
Insulation strength, Ohm		≥ 5000
AC peak power (V/min)		2500
Voltage standing-wave ratio (VSWR)		≤ 1.10

N OUTER CONNECTOR FOR COAXIAL CABLE 1.1/4"

Connectors are manufactured in accordance with IEC60169-16

Screw thread: 5/8-24UNEF-2A

Materials and covering

Item	Material	Covering
Outer conductor	Brass (H59-1)	Nickel covering $\geq 3 \mu m$
Limiting screw nut	Brass (H59-1)	Nickel covering $\geq 3 \mu m$
Inner conductor	Bronze	Silver covering $\geq 3 \mu m$
Locking ring	Bronze	
Connecting nut	Brass (H59-1)	Nickel covering $\geq 3 \mu m$
Gasket	Silicon spacer	
Insulation	PTFE (teflon)	

1. Conditions

Working temperature: $-40 \sim +85^{\circ}C$

Relative humidity: 90% ~ 95% ($40 \pm 2\%$)

Atmospheric pressure: 70 ~ 106 kPa

Salt fog: long-lasting fog for 48 hours (5% NaCl)

2. Dimensions:

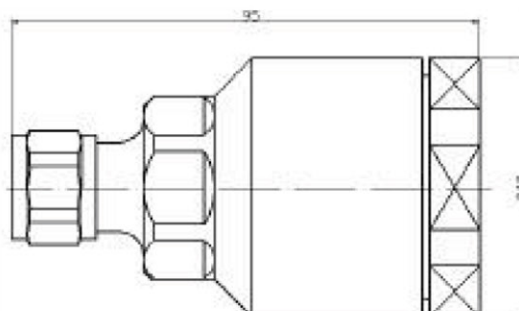

3. Electric characteristics:

Wave resistance, Ohm	Outer conductor	≤ 0.25
	Inner conductor	≤ 1
Insulation strength, Ohm		≥ 5000
AC peak power (V/min)		2500
Voltage standing-wave ratio (VSWR)		≤ 1.10

7/16 INNER CONNECTOR FOR COAXIAL CABLE 7/8"

1. Connectors are manufactured in accordance with IEC60169-4 standard
2. Screw thread: M29 x 1.5 – 6g
3. Materials and covering

Item	Material	Covering
Outer conductor	Brass (H59-1)	Silver covering $\geq 3 \mu m$
Limiting screw nut	Brass (H59-1)	Nickel covering $\geq 3 \mu m$
Inner conductor	Bronze	Silver covering $\geq 5 \mu m$
Gasket	Silicon spacer	
Insulation	PTFE (teflon)	

4. Conditions

Working temperature: $-40 \sim +85^{\circ}C$

Relative humidity: 90%~95% ($40 \pm 2\%$)

Atmospheric pressure: 70~106Kpa

Salt fog: long-lasting fog for 48 hours (5% NaCl)

5. Dimensions:

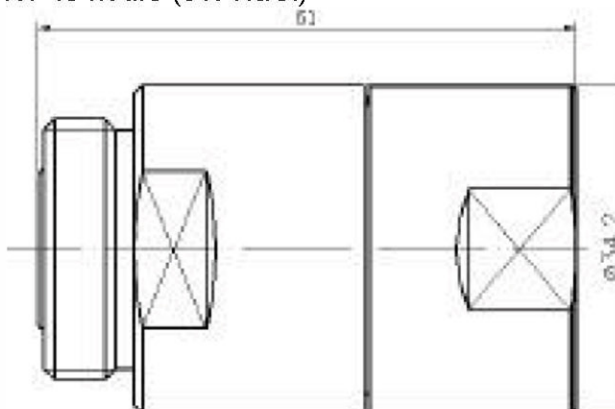

6. Electric characteristics:

Wave resistance, Ohm	Outer conductor	≤ 0.2
	Inner conductor	≤ 0.4
Insulation strength, Ohm		$\geq 10^4$
AC peak power (V/min)		4000
Voltage standing-wave ratio (VSWR)		≤ 1.10

7/16 OUTER CONNECTOR FOR COAXIAL CABLE 7/8"

Connectors are manufactured in accordance with IEC60169-4 standard

Screw thread: M29 x 1.5 – 7H

Materials and covering

Item	Material	Covering
Outer conductor	Brass (H59-1)	Nickel covering $\geq 3 \mu\text{m}$
Limiting screw nut	Brass (H59-1)	Nickel covering $\geq 3 \mu\text{m}$
Inner conductor	Bronze	Silver covering $\geq 3 \mu\text{m}$
Insertable stud	Brass (H59-1)	Silver covering $\geq 3 \mu\text{m}$
Connecting nut	Brass (H59-1)	Nickel covering $\geq 3 \mu\text{m}$
Gasket	Silicon spacer	
Insulation	PTFE (teflon)	

1. Conditions

Working temperature: $-40 \sim +85^{\circ}\text{C}$

Relative humidity: 90% ~ 95% ($40 \pm 2\%$)

Atmospheric pressure: 70 ~ 106 kPa

Salt fog: long-lasting fog for 48 hours (5% NaCl)

2. Dimensions:

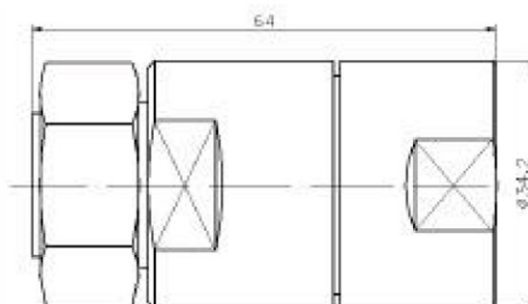

3. Electric characteristics:

Wave resistance, Ohm	Outer conductor	≤ 0.2
	Inner conductor	≤ 0.4
Insulation strength, Ohm		$\geq 10^4$
AC peak power (V/min)		4000
Voltage standing-wave ratio (VSWR)		≤ 1.10

N INNER CONNECTOR FOR COAXIAL CABLE 7/8"

1. Connectors are manufactured in accordance with IEC60169-16 standard
2. Screw thread: 5/8-24UNEF-2B
3. Materials and covering

Item	Material	Covering
Outer conductor	Brass (H59-1)	Nickel covering $\geq 3 \mu m$
Limiting screw nut	Brass (H59-1)	Nickel covering $\geq 3 \mu m$
Inner conductor	Bronze	Golden covering
Gasket	Silicon spacer	
Insulation	PTFE (teflon)	

4. Conditions

Working temperature: $-40 \sim +85^{\circ}\text{C}$

Relative humidity: 90% ~ 95% ($40 \pm 2\%$)

Atmospheric pressure: 70 ~ 106 kPa

Salt fog: long-lasting fog for 48 hours (5% NaCl)

5. Dimensions:

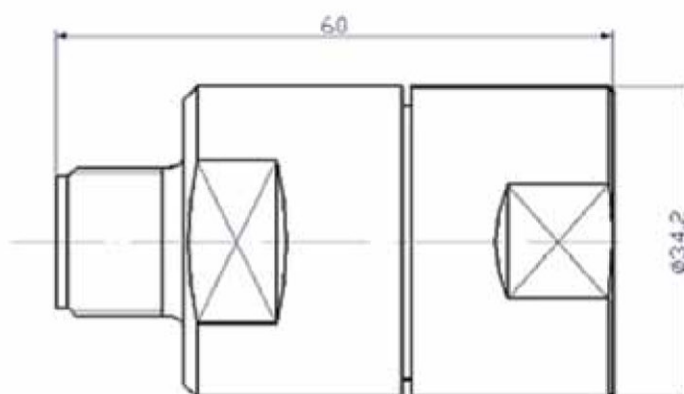

6. Electric characteristics

Wave resistance, Ohm	Outer conductor	≤ 0.25
	Inner conductor	≤ 1
Insulation strength, Ohm		≥ 5000
AC peak power (V/min)		2500
Voltage standing-wave ratio (VSWR)		≤ 1.10

N OUTER CONNECTOR FOR COAXIAL CABLE 7/8"

Connectors are manufactured in accordance with IEC60169-16

Screw thread: 5/8-24UNEF-2A

Materials and covering

Item	Material	Covering
Outer conductor	Brass (H59-1)	Nickel covering $\geq 3 \mu\text{m}$
Limiting screw nut	Brass (H59-1)	Nickel covering $\geq 3 \mu\text{m}$
Inner conductor	Bronze	Golden covering
Locking ring	Bronze	
Connecting nut	Brass (H59-1)	Nickel covering $\geq 3 \mu\text{m}$
Gasket	Silicon spacer	
Insulation	PTFE (teflon)	

1. Conditions

Working temperature: $-40 \sim +85^{\circ}\text{C}$

Relative humidity: 90% ~ 95% ($40 \pm 2\%$)

Atmospheric pressure: 70 ~ 106 kPa

Salt fog: long-lasting fog for 48 hours (5% NaCl)

2. Dimensions:

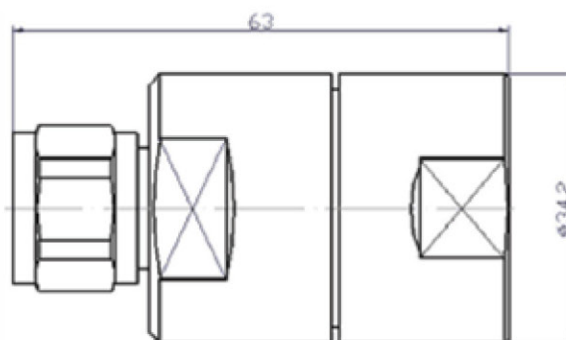

3. Electric characteristics:

Wave resistance, Ohm	Outer conductor	≤ 0.25
	Inner conductor	≤ 1
Insulation strength, Ohm		≥ 5000
AC peak power (V/min)		2500
Voltage standing-wave ratio (VSWR)		≤ 1.10

7/16 INNER CONNECTOR FOR COAXIAL CABLE 1/2"

Connectors are manufactured in accordance with IEC60169-4 standard

Screw thread: M29 x 1.5 – 6G

Materials and covering

Item	Material	Covering
Outer conductor	Brass (H59-1)	Nickel covering $\geq 3 \mu\text{m}$
Limiting screw nut	Brass (H59-1)	Nickel covering $\geq 3 \mu\text{m}$
Inner conductor	Bronze	Silver covering $\geq 3 \mu\text{m}$
Insert opening	Bronze	Silver covering $\geq 3 \mu\text{m}$
Gasket	Silicon spacer	
Insulation	PTFE (teflon)	

1. Conditions

Working temperature: $-40 \sim +85^{\circ}\text{C}$

Relative humidity: 90% ~ 95% ($40 \pm 2\%$)

Atmospheric pressure: 70 ~ 106 kPa

Salt fog: long-lasting fog for 48 hours (5% NaCl)

2. Dimensions:

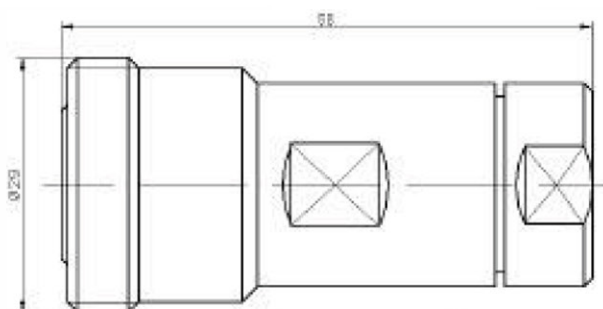

3. Electric characteristics:

Wave resistance, Ohm	Outer conductor	≤ 0.2
	Inner conductor	≤ 0.4
Insulation strength, Ohm		$\geq 10^4$
AC peak power (V/min)		4000
Voltage standing-wave ratio (VSWR)		≤ 1.10

7/16 OUTER CONNECTOR FOR COAXIAL CABLE 1/2"

Connectors are manufactured in accordance with IEC60169-4 standard

Screw thread: M29 x 1.5 – 7H

Materials and covering

Item	Material	Covering
Outer conductor	Brass (H59-1)	Nickel covering $\geq 3 \mu m$
Limiting screw nut	Brass (H59-1)	Nickel covering $\geq 3 \mu m$
Inner conductor	Bronze	Silver covering $\geq 3 \mu m$
Insertable stud	Brass (H59-1)	Silver covering $\geq 3 \mu m$
Connecting nut	Brass (H59-1)	Nickel covering $\geq 3 \mu m$
Gasket	Silicon spacer	
Insulation	PTFE (teflon)	

1. Conditions

Working temperature: $-40 \sim +85^{\circ}C$

Relative humidity: 90% ~ 95% ($40 \pm 2\%$)

Atmospheric pressure: 70 ~ 106 kPa

Salt fog: long-lasting fog for 48 hours (5% NaCl)

2. Dimensions:

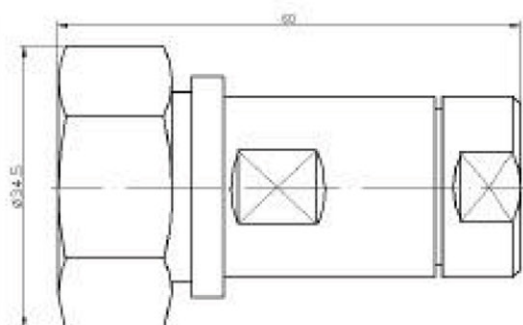

3. Electric characteristics:

Wave resistance, Ohm	Outer conductor	≤ 0.2
	Inner conductor	≤ 0.4
Insulation strength, Ohm		$\geq 10^4$
AC peak power (V/min)		4000
Voltage standing-wave ratio (VSWR)		≤ 1.10

N INNER CONNECTOR FOR COAXIAL CABLE 1/2"

1. Connectors are manufactured in accordance with IEC60169-16 standard
2. Screw thread: 5/8-24UNEF-2B
3. Materials and covering

Item	Material	Covering
Outer conductor	Brass (H59-1)	Nikel covering $\geq 3 \mu m$
Limiting screw nut	Brass (H59-1)	Nickel covering $\geq 3 \mu m$
Inner conductor	Bronze	Golden covering
Gasket	Silicon spacer	
Insulation	PTFE (teflon)	

4. Conditions

Working temperature: $-40 \sim +85^{\circ}\text{C}$

Relative humidity: 90% ~ 95% ($40 \pm 2\%$)

Atmospheric pressure: 70 ~ 106 kPa

Salt fog: long-lasting fog for 48 hours (5% NaCl)

5. Dimensions:

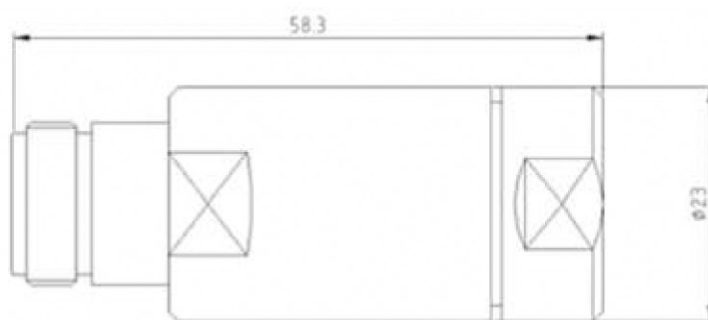

6. Electric characteristics

Wave resistance, Ohm	Outer conductor	≤ 0.25
	Inner conductor	≤ 1
Insulation strength, Ohm		≥ 5000
AC peak power (V/min)		2500
Voltage standing-wave ratio (VSWR)		≤ 1.10

N OUTER CONNECTOR FOR COAXIAL CABLE 1/2"

Connectors are manufactured in accordance with IEC60169-16

Screw thread: 5/8-24UNEF-2A

Materials and covering

Item	Material	Covering
Outer conductor	Brass (H59-1)	Nickel covering $\geq 3 \mu m$
Limiting screw nut	Brass (H59-1)	Nickel covering $\geq 3 \mu m$
Inner conductor	Bronze	Golden covering
Locking ring	Bronze	
Connecting nut	Brass (H59-1)	Nickel covering $\geq 3 \mu m$
Gasket	Silicon spacer	
Insulation	PTFE (teflon)	

1. Conditions

Working temperature: $-40 \sim +85^{\circ}C$

Relative humidity: 90% ~ 95% ($40 \pm 2\%$)

Atmospheric pressure: 70 ~ 106 kPa

Salt fog: long-lasting fog for 48 hours (5% NaCl)

2. Dimensions:

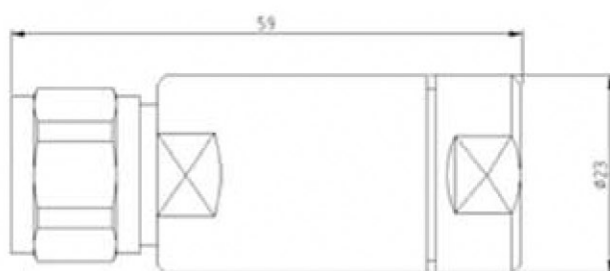

3. Electric characteristics:

Wave resistance, Ohm	Outer conductor	≤ 0.25
	Inner conductor	≤ 1
Insulation strength, Ohm		≥ 5000
AC peak power (V/min)		2500
Voltage standing-wave ratio (VSWR)		≤ 1.10

7/16 INNER CONNECTOR FOR COAXIAL CABLE 1/2"

1. Connectors are manufactured in accordance with IEC60169-4 standard
2. Screw thread: M29 x 1.5 – 6G
3. Materials and covering

Item	Material	Covering
Outer conductor	Brass (H59-1)	Nickel covering $\geq 3 \mu m$
Limiting screw nut	Brass (H59-1)	Nickel covering $\geq 3 \mu m$
Inner conductor	Bronze	Silver covering $\geq 5 \mu m$
Insert opening	Bronze	Silver covering $\geq 3 \mu m$
Gasket	Silicon spacer	
Insulation	PTFE (teflon)	

4. Conditions

Working temperature: $-40 \sim +85^{\circ}\text{C}$

Relative humidity: 90%~95% ($40 \pm 2\%$)

Atmospheric pressure: 70~106Kpa

Salt fog: long-lasting fog for 48 hours (5% NaCl)

5. Dimensions:

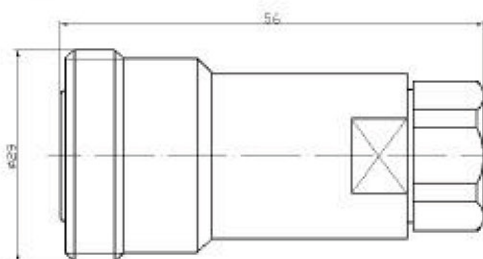

6. Electric characteristics:

Wave resistance, Ohm	Outer conductor	≤ 0.2
	Inner conductor	≤ 0.4
Insulation strength, Ohm		$\geq 10^4$
AC peak power (V/min)		4000
Voltage standing-wave ratio (VSWR)		≤ 1.10

7/16 OUTER CONNECTOR FOR COAXIAL CABLE 1/2"

SUPER-FLEXIBLE

Connectors are manufactured in accordance with IEC60169-4 standard

Screw thread: M29 x 1.5 – 7H

Materials and covering

Item	Material	Covering
Outer conductor	Brass (H59-1)	Nickel covering $\geq 3 \mu\text{m}$
Limiting screw nut	Brass (H59-1)	Nickel covering $\geq 3 \mu\text{m}$
Inner conductor	Bronze	Silver covering $\geq 3 \mu\text{m}$
Insertable stud	Brass (H59-1)	Silver covering $\geq 3 \mu\text{m}$
Connecting nut	Brass (H59-1)	Nickel covering $\geq 3 \mu\text{m}$
Gasket	Silicon spacer	
Insulation	PTFE (teflon)	

1. Conditions

Working temperature: $-40 \sim +85^{\circ}\text{C}$

Relative humidity: 90% ~ 95% ($40 \pm 2\%$)

Atmospheric pressure: 70 ~ 106 kPa

Salt fog: long-lasting fog for 48 hours (5% NaCl)

2. Dimensions:

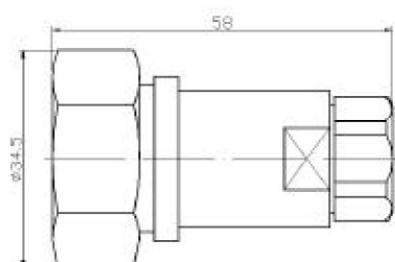

3. Electric characteristics:

Wave resistance, Ohm	Outer conductor	≤ 0.2
	Inner conductor	≤ 0.4
Insulation strength, Ohm		$\geq 10^4$
AC peak power (V/min)		4000
Voltage standing-wave ratio (VSWR)		≤ 1.10

N INNER CONNECTOR FOR COAXIAL CABLE 1/2"

SUPER-FLEXIBLE

1. Connectors are manufactured in accordance with IEC60169-16 standard
2. Screw thread: 5/8-24UNEF-2B
3. Materials and covering

Item	Material	Covering
Outer conductor	Brass (H59-1)	Nickel covering $\geq 3 \mu m$
Limiting screw nut	Brass (H59-1)	Nickel covering $\geq 3 \mu m$
Inner conductor	Bronze	Golden covering
Gasket	Silicon spacer	
Insulation	PTFE (teflon)	

4. Conditions

Working temperature: $-40 \sim +85^{\circ}C$

Relative humidity: 90% ~ 95% ($40 \pm 2\%$)

Atmospheric pressure: 70 ~ 106 kPa

Salt fog: long-lasting fog for 48 hours (5% NaCl)

5. Dimensions:

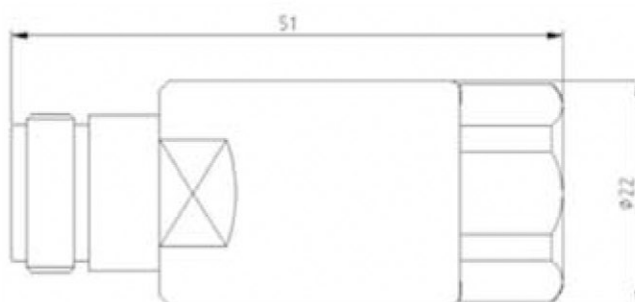

6. Electric characteristics

Wave resistance, Ohm	Outer conductor	≤ 0.25
	Inner conductor	≤ 1
Insulation strength, Ohm		≥ 5000
AC peak power (V/min)		2500
Voltage standing-wave ratio (VSWR)		≤ 1.10

N OUTER CONNECTOR FOR COAXIAL CABLE 1/2"

SUPER-FLEXIBLE

Connectors are manufactured in accordance with IEC60169-16

Screw thread: 5/8-24UNEF-2A

Materials and covering

Item	Material	Covering
Outer conductor	Brass (H59-1)	Nickel covering $\geq 3 \mu m$
Limiting screw nut	Brass (H59-1)	Nickel covering $\geq 3 \mu m$
Inner conductor	Bronze	Golden covering $\geq 3 \mu m$
Locking ring	Bronze	
Connecting nut	Brass (H59-1)	Nickel covering $\geq 3 \mu m$
Gasket	Silicon spacer	
Insulation	PTFE (teflon)	

1. Conditions

Working temperature: $-40 \sim +85^{\circ}C$

Relative humidity: 90% ~ 95% ($40 \pm 2\%$)

Atmospheric pressure: 70 ~ 106 kPa

Salt fog: long-lasting fog for 48 hours (5% NaCl)

2. Dimensions:

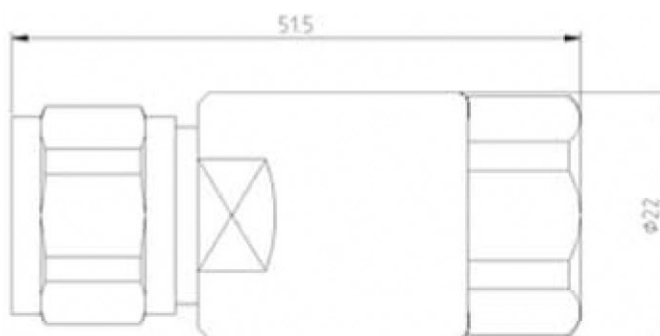

3. Electric characteristics:

Wave resistance, Ohm	Outer conductor	≤ 0.25
	Inner conductor	≤ 1
Insulation strength, Ohm		≥ 5000
AC peak power (V/min)		2500
Voltage standing-wave ratio (VSWR)		≤ 1.10

COAXIAL ADAPTER (INNER AND OUTER)

1. Connectors are manufactured in accordance with IEC60169-16 standard
2. Screw thread: 5/8-24UNEF-2A
3. Materials and covering

Item	Material	Covering
Outer conductor	Brass (H59-1)	Nickel covering $\geq 3 \mu m$
Inner conductor	Bronze	Golden covering
Locking ring	Bronze	
Connecting nut	Brass (H59-1)	Nickel covering $\geq 3 \mu m$
Insulation	PTFE (teflon)	

4. Conditions

Working temperature: $-40 \sim +85^{\circ}\text{C}$

Relative humidity: 90% ~ 95% ($40 \pm 2\%$)

Atmospheric pressure: 70 ~ 106 kPa

Salt fog: long-lasting fog for 48 hours (5% NaCl)

5. Dimensions:

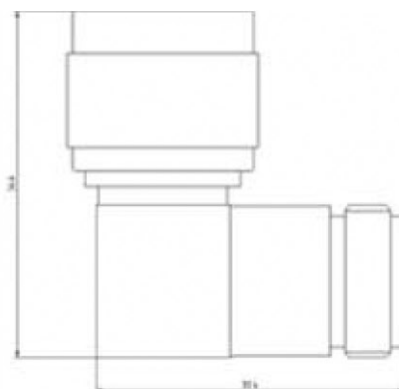

6. Electric characteristics

Wave resistance, Ohm	Outer conductor	≤ 0.25
	Inner conductor	≤ 1
Insulation strength, Ohm		≥ 5000
AC peak power (V/min)		2500
Voltage standing-wave ratio (VSWR)		≤ 1.10
IM3 (dB)		≤ -150